

Nakrętka kołnierzowa - RLY Nut - RLY

Material/Material: 1.1191, 30-32HRC

Norma/Standard: DIN 6331

Klasa/Class: 10.9

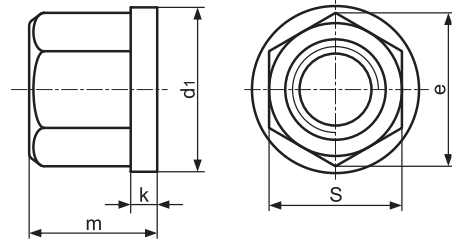

| d | d ₁ | k | m | e | S | Ciężar (kg) Weight | Nr katalogowy Item no. |
|------------|----------------|-----|----|------|----|-----------------------|---------------------------|
| M8 | 18 | 3,5 | 12 | 15 | 13 | 0,012 | RLY-08 |
| M10 | 22 | 4 | 15 | 19,7 | 17 | 0,025 | RLY-10 |
| M12 | 25 | 4 | 18 | 21,9 | 19 | 0,035 | RLY-12 |
| M14 | 28 | 4,5 | 21 | 25,4 | 22 | 0,050 | RLY-14 |
| M16 | 31 | 5 | 24 | 27,7 | 24 | 0,070 | RLY-16 |
| M18 | 34 | 5 | 27 | 31,2 | 27 | 0,095 | RLY-18 |
| M20 | 37 | 6 | 30 | 34,6 | 30 | 0,130 | RLY-20 |
| M22 | 40 | 6 | 33 | 36,9 | 32 | 0,160 | RLY-22 |
| M24 | 45 | 6 | 36 | 41,5 | 36 | 0,230 | RLY-24 |
| M30 | 58 | 8 | 45 | 53,1 | 46 | 0,470 | RLY-30 |