

Śruba dwustronna - RLR Stud - RLR

Material/Material: 1.7035, kształtowany na gorąco, gwint walcowany / forged, rolled thread

Norma/Standard: DIN 6379

Klasa/Class: 10.9

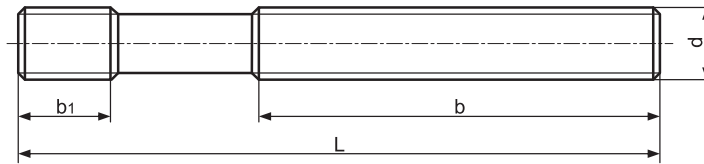

Nr katalogowy Item no.	d	b ₁	b	L	Ciężar (kg) Weight
RLR-08040	M8	11	20	40	0,01
RLR-08063			40	63	0,02
RLR-08080			50	80	0,025
RLR-08100			63	100	0,03
RLR-08125			75	125	0,035
RLR-08160			100	160	0,045
RLR-10050	M10	13	25	50	0,025
RLR-10063			32	63	0,035
RLR-10080			50	80	0,040
RLR-10100			75	100	0,050
RLR-10125			75	125	0,060
RLR-10160			100	160	0,080
RLR-10200	M12	15	125	200	0,100
RLR-12050			25	50	0,035
RLR-12063			32	63	0,045
RLR-12080			50	80	0,055
RLR-12100			63	100	0,070
RLR-12125			75	125	0,090
RLR-12160	M14	17	100	160	0,115
RLR-12200			125	200	0,140
RLR-14063			32	63	0,095
RLR-14080			50	80	0,090
RLR-14100			63	100	0,095
RLR-14125			75	125	0,120
RLR-14160	M16	19	100	160	0,150
RLR-14200			125	200	0,195
RLR-14250			160	250	0,240
RLR-16063			32	63	0,085
RLR-16080			50	80	0,105
RLR-16100			63	100	0,130
RLR-16125	M18	23	75	125	0,160
RLR-16160			100	160	0,220
RLR-16200			125	200	0,280
RLR-16250			160	250	0,325
RLR-16315			180	315	0,425
RLR-16500			315	500	0,650
RLR-18080	M18	23	50	80	0,130
RLR-18100			60	100	0,160
RLR-18125			75	125	0,200
RLR-18160			100	160	0,260
RLR-18200			125	200	0,320
RLR-18250			150	250	0,400
RLR-18315	M18	23	180	315	0,500

Nr katalogowy Item no.	d	b ₁	b	L	Ciężar (kg) Weight
RLR-20080	M20	27	32	80	0,190
RLR-20100			60	100	0,220
RLR-20125			70	125	0,260
RLR-20160			100	160	0,330
RLR-20200			125	200	0,410
RLR-20250			160	250	0,510
RLR-20315	M22	31	200	315	0,640
RLR-20400			250	400	0,815
RLR-20500			315	500	1,020
RLR-22100			45	100	0,270
RLR-22125			60	125	0,330
RLR-22160			100	160	0,430
RLR-22200	M24	35	125	200	0,500
RLR-22250			160	250	0,670
RLR-22315			180	315	0,790
RLR-22400			250	400	1,070
RLR-24100			45	100	0,290
RLR-24125			70	125	0,380
RLR-24160	M24	35	100	160	0,470
RLR-24200			125	200	0,580
RLR-24250			160	250	0,730
RLR-24315			200	315	0,920
RLR-24400			250	400	1,160
RLR-24500			315	500	1,450
RLR-24630	M30	43	315	630	1,650
RLR-30125			56	125	0,600
RLR-30200			125	200	0,950
RLR-30250			160	250	1,230
RLR-30315			200	315	1,500
RLR-30500			315	500	2,360
RLR-30700	M36	51	400	700	3,300
RLR-301000			400	1000	4,700
RLR-36160			80	160	1,100
RLR-36200			125	200	1,340
RLR-36250			160	250	1,710
RLR-36315			200	315	2,150
RLR-36400	M42	59	250	400	2,700
RLR-36500			315	500	3,450
RLR-36700			400	700	4,750
RLR-42315			200	315	2,950
RLR-42400			250	400	3,750
RLR-42500			315	500	4,690